

## Epson SureColor F560 - 24"

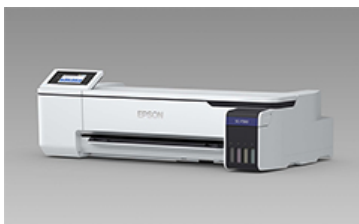

[+ ENLARGE IMAGE](#)

### Large Format Printers

[Printer Friendly Specs](#)

[Where to Buy](#)

### Overview

The Epson SureColor DS series has long offered a superior production platform; developed from the ground up for Dye Sublimation, it combines superior image quality, better colour, lower running costs, and higher reliability, all backed with a comprehensive factory warranty. The F560 takes the concept further with a low-cost package that provides a total imaging solution complete with software, ink and media. Designed for custom merchandise and décor production, it is also suited to photo imaging, hard signage, and even small fabric applications. It features a compact design with flexible media support, and a Continuous Ink Supply System (CISS). Prints are made on paper which transfers (sublimates) via a heat press onto material with a polyester base or polyester pre-treatment.



The SC-F560 is designed for an ad-hoc workflow and low production volumes. It features the latest Epson print head technology and has a media handling system that supports operation with sheet and roll stocks. It uses advanced Epson Dye Sublimation ink that is loaded into a small tank system using inexpensive bottles. The print head and ink work together to enable outstanding image quality with fine gradation, a wide gamut, and high colour density. The engine supports production speeds up to 21m<sup>2</sup>/hr while an integrated auto-cutter enables sheet-based output for operation with a wide variety of inexpensive 3<sup>rd</sup> party heat presses.

#### FEATURES AT A GLANCE

**Superior Quality** – latest Epson PrecisionCore™ (TFP) print head and UltraChrome™ Dye Sub ink for precise imaging with superior colour at resolutions up to 2400x1200dpi, Epson Precision Dot Technology for prints with fine gradation, an expanded gamut, and low grain.

**Superior Reliability** – designed to minimise dust and moisture intrusion, print head has an integrated crash guard, supplied with a comprehensive single-source manufacturer warranty augmented with optional CoverPlus for up to 3 years protection complete with on-site service<sup>1</sup>

**Superior Flexibility** – supports rolls up to 24" (610mm) and multipage A4/A3 sheet feeder with auto-switching, offers a range of print modes to suit different production and output requirements.

**Choice of two ink sets** – CMYK (SC-F560) and CfpYK (SC-F561) with two channels of Fluorescent ink that can be combined with Cyan and Black to produce a full rainbow of extra bright fluoro colours.<sup>4</sup>

**High Productivity** – produce an A4 print for rigid sublimation or A1 for fabric in around a minute, tank-based ink system can be refilled while printing is underway; incorporates an auto-cutter.

**Low Running Costs** – low power and ink consumption, ink tanks refilled using inexpensive bottles, ships with Epson Accounting software for job costing<sup>1</sup>

**Easy to Install** – compact design, desktop mountable, ships with media and over 1L of ink, optional floor stand with media basket, simple setup, flexible WiFi/Ethernet/USB networking

**Easy to Operate** – all top-loaded consumables, large touch-panel display with in-built help, advanced driver enables operation with standard graphic software, supplied complete with high-precision Epson Edge Print software.<sup>1 2</sup>





#### OUTSTANDING QUALITY

The SureColor F560 incorporates an Epson PrecisionCore™ Thin Film print head with micro-fine nozzles that enable ultra-high resolution imaging with pinpoint accuracy. Driven by Epson Precision Dot Technology it facilitates precise and predictable colour with superior density, and enhanced tonal expression. The printer has a range of print modes to suit different quality levels, production speeds, and sublimation media types. It suits a wide range of applications including art and photography, hard and soft signage, short run merchandise and décor, custom fabric and clothing.



The SC-F560 uses a simple 4 colour imaging system. The advanced UltraChrome Dye Sub ink works in conjunction with the print head to produce superior output with a lower production cost and enhanced mechanical reliability. When sublimated it produces a colour gamut that is equal or better than competing solutions with many more colours. It produces images with outstanding light and wash fastness, that are resistant to damage through abrasion and perspiration. When applied to polyester fabrics, the material conforms to the latest Oeko-Tex Eco Passport® standard and certified safe for use by adults, children and babies.<sup>2,3</sup>



#### FLEXIBLE WORKFLOW

The SureColor F560 is extremely compact with a footprint that is just 0.5m<sup>2</sup>. It can be mounted on a desk with single page prints held on exit to minimise mess and spoilage. It can also be floor mounted via an optional stand that incorporates a media basket for multi-page work. It supports both sheet and roll media with a convenient A4/A3 multi-sheet feeder and auto-switching. It ships with a spindle that supports roll media up to 24" (610mm) wide. Additional spindles can be purchased separately to facilitate easy storage with rapid roll exchange. The printer is designed to be operated in conjunction with a flat sheet or specialty merchandise heat press and incorporates a rotary auto-cutter with selectable manual and automatic operation.<sup>1</sup>



The Epson DS Fabric series has been designed for reliable and cost-effective operation. The F560 features a Continuous Ink Supply System (CISS) that can be refilled while printing is underway using inexpensive 140ml bottles. The printer can be managed via a front panel LCD with in-built help, or from a PC or Mac using the supplied driver and utility software. The engine features extremely low power consumption with sleep and standby modes to further reduce costs.



#### EASY TO INSTALL & CONFIGURE

Dye sublimation is designed to replace traditional screen printing. It is considerably simpler and less expensive for short to medium production runs with less labour, less materials, and less wastage. Digital imaging enables easier content creation and editing, more accurate and flexible reproduction. Production is mess-free and requires less space. Job turnaround is faster with accurate repeats able to be created at the push of a button. The process suits imaging onto fabric with a high polyester content and hard surface materials that will accept a polyester spray and withstand a moderate amount of heat and pressure. A wide range of products can be produced, including fabric banners and metal signage, custom cabinetry and sporting goods, phone covers and tablet cases, footwear ('thongs') and sportswear, wall decorations and home décor.

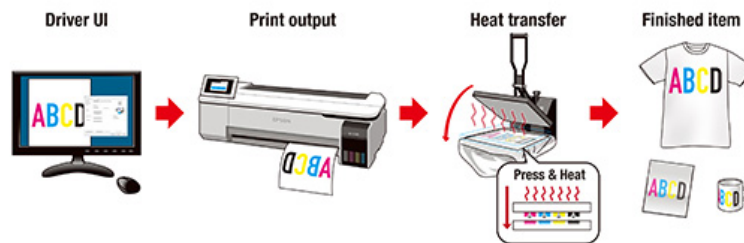

The SureColor F560 runs off a standard 240V power supply and can be driven by a PC of moderate specification. The printer ships complete with ink and media. It also ships with a driver that enables operation with standard graphic software. Additional Epson Accounting software assists with cost control while optional **Edge Print** software enables enhanced high-precision production with PostScript control.<sup>1</sup>



<sup>1</sup> A PC with moderate specifications, appropriate graphic software, a suitable sublimation device, and compatible output media will be required to enable production; customers are recommended to speak with their Authorised Epson Large Format Fabric Dealer for details and options. Some software is Windows only and some applications may require internet access for download, registration, &/or periodic update. Customers who purchase a printer sourced through Epson Australia will be provided with an additional ink/media pack as well as a FREE copy of Epson Edge print. After-sales warranty and CoverPlus service is subject to a range of terms and conditions including operation within mechanical life ratings, the use of correct and genuine consumables; please see the specs page and [warranty page](#) for further information.

<sup>2</sup>Dye Sub ink is relatively delicate prior to sublimation and needs to be handled with care. Please see the specs page for further information.

<sup>3</sup>ECO PASSPORT by OEKO-TEX® is an international standard for the textile industry system. It enables suppliers to demonstrate that products can be used in sustainable textile production. For further information please see the [OEKO-TEX web site](#).

<sup>4</sup>This model comes in two variants with separate ink sets; Y & M ink can only be used in the F560 while Fp & Fy ink can only be used in the F561.

## Specification

<b>SIZE</b>	
Max Media Width	24 inch wide (610mm)
<b>PRINT TECHNOLOGY</b>	
Print Head	PrecisionCore TFP with VSDT and Auto Head Alignment
Print Modes	Uni & Bi-directional
Nozzle Configuration	800 per colour
Maximum Resolution	2400 x 1200dpi
<b>INK SYSTEM</b>	

Family	Epson Ultrachrome® Dye Sublimation	
Type	Dye Sublimation	
Colours	SC-F560: CMYK / SC-F561: CFyFpBk*	
Supply	4 x 106ml Tank System	
Refills	140ml Bottles	
*Ink sets are not interchangeable between models		
<b>PERFORMANCE</b>		
Fast Fabric	21m <sup>2</sup> /hr	62s per A1 (2 pass @ 600x1200dpi)
Standard Fabric / Fast Rigid	7.5m <sup>2</sup> /hr	208s per A1 (7 pass @ 1200x1200dpi)
Max Quality	4.5m <sup>2</sup> /hr	350s per A1 (12 pass @ 2400x1200dpi)
<p><i>Figures represent print times only based on the test sample image as shown, produced on Epson Multi-Purpose DS Paper using Epson Edge Print. The total throughput time for a particular job will depend on a number of factors including the PC specification, RIP application, workflow configuration, networking, file format / size, image content, paper type, print mode, Auto-Take-Up activation and Heater activation.</i></p>		
<b>MEDIA SUPPORT</b>		
Handling	Roll and sheet media with auto-switching	
Roll Format	Epson General Purpose Transfer Paper (single roll with spindle loading)	
Sheet Format	Epson General Purpose Transfer Paper (A3/A4 with 50 sheet max pop-up feeder)	
Minimum Margins	3mm top, bottom, left & right (45mm top & 15mm bottom for optimum quality)	
Output	Single sheet with auto-cutter and hold on exit Supplied with an A4/A3 output tray	
<b>OPERATION</b>		
Control Panel	4.3" Colour LCD touch screen	
Interface	USB 3.0 & Ethernet 10Base-T/100Base-TX/1000Base-T, WiFi & WiFi Direct	
Memory	1GB RAM	
Included Software	<p>Windows Printer Driver, EpsonNet Setup, EpsonNet Print, EpsonNet Config, Epson Software Updater, LFP Print Plug-in for Office and Epson Edge Print on CD Firmware Updater, EpsonNet Setup Manager &amp; Epson Accounting Tool via <a href="#">web download</a></p> <p>Mac Printer Driver, EpsonNet Config, Epson Software Updater, Firmware Updater and Software Uninstaller via (<a href="#">Web download</a>)</p>	
System Requirements	<p>Windows 10/8.1/8/7(32/64bit) or later (64bit required for Edge Print), Core 2 Duo 3.05GHz or greater Processor, 2GB RAM (4GB recommended), 32GB HDD (250GB recommended)</p> <p>Mac OSX 10.7 / OS 10.12 or later, Core2Duo 3.05GHz or greater Processor, 1GB RAM, 32GB HDD (250GB recommended)</p>	
<b>ENVIRONMENTAL</b>		
Physical (WxHxD)	970 x 245 x 577mm, 29kg (no consumables, stand, or output tray, ASF closed)	
Power Supply	AC 220~240V, 50/60Hz, 1.4A	
Operational Temp	10°~35°C (15°~25°C recommended)	
Operational Humidity	20 to 80% with no condensation (40-60% recommended)	
Power Consumption	22W Operating, 8W Standby, 1.6W Sleep	
Operating Noise	49dB	
Recommended Operational Space (WxHxD)	<p>Desktop: 1020 x 395 x 1035mm Floor-standing: 1020 x 1078 x 1000mm (additional space will be required for a heat press)</p>	
<b>SHIPPING INFO</b>		
Packaging (WxDxH)	<p>Printer: 1106 x 718 x 558mm, 50Kg Ink &amp; Media Pack: 450 x 250 x 250mm, 5Kg</p>	
What's in the Box	Printer, 2 x Ink Bottle Set, 2 x Maintenance Tank, Sample Media Pack, Power Cord, Setup Guide, Software & User Manual CD.	
Installation & Operation	<p>A heat press will be required to enable production; details on models, features and pricing can be provided by your Epson Authorised Large Format Fabric Dealer.</p> <p>Some assembly and configuration will be required. A set-up guide is included to assist with this process.</p> <p>Two ink sets and 2 maintenance tanks are included with this printer; a proportion of the first set and one of the maintenance tanks will be used to 'prime' the printer during initial set-up.</p> <p>This printer is designed to be used with specific Epson media. While use of alternative media may be possible Epson is unable to provide any guidance or guarantees in regards reliability, performance, print or sublimation quality.</p> <p>Delivery, de-boxing and package removal is not typically included but can be provided at an additional charge for most locations. Reliable operation requires the printer to be used on a regular basis and not left powered down for extended periods. The printer is not designed for mobile operation and prior to transport it is recommended that ink be</p>	

removed. Dye sub ink is extremely stable once sublimated however care must be taken prior to this; unopened bottles should be stored in a cool environment away from sunlight and consumed by the best before date printed on the package, ink should be consumed within one month of loading into tanks, opened bottles should be consumed within 6 months, and prints should be sublimated within a week of creation (1~2 days recommended).

This printer is designed to operate with specific consumables and be used for ad-hoc / low volume work. It does not suit applications which require continuous &/or high volume production. Please refer to the [warranty section](#) for details on operational and mechanical life rating limitations.

#### CONFIGURATION OPTIONS\*\*

SCF5601YR	Standard Model with 1Yr Warranty
SCF5603YR	Standard Model with 1Yr Warranty & 2Yr CoverPlus (3 yrs total cover)
SCF5611YR	Fluro Model with 1Yr Warranty
SCF5613YR	Fluro Model with 1Yr Warranty & 2Yr CoverPlus (3 yrs total cover)

#### ACCESSORIES & OPTIONS\*\*

C12C933151	Optional Stand with media bin
C12C933211	Additional Roll Media Spindle
1YWF560	1Yr CoverPlus On-Site Service Pack
2YWF560	2Yr CoverPlus On-Site Service Pack
1YWF561	1Yr CoverPlus On-Site Service Pack
2YWF561	2Yr CoverPlus On-Site Service Pack

#### SERVICE & SUPPORT

\*\*Printers is supplied with a comprehensive 1 year warranty that covers labour and all non-consumable parts (including Print Heads but excluding the tank system). It provides for free-on-site repair of equipment located in all metro areas (regional locations will attract an additional travelling charge). Cover can be extended up to a maximum of 3 years through purchase of optional CoverPlus packages either with the printer or up to 365 days subsequent to purchase (discounts apply for bundled purchase). CoverPlus provides additional cover for the tank system while extending the base parts and labour cover.

Support and Service is provided via authorised Epson authorised Large Format Fabric Dealers. If you have a problem with a SureColor Fabric printer, a related option or consumable please contact your dealer for initial problem evaluation. Should a printer require service this will be provided on-site free of charge within the period covered by your Warranty and any optional

Important: Warranty and CoverPlus may be restricted or denied if the user does not perform maintenance & cleaning as outlined in the user guide &/or advised by Epson Australia or New Zealand, if equipment is modified, used outside of specification &/or with non-Epson consumables. Please refer to the [warranty section](#) of this web site for details and contact Epson or one of our Authorised Resellers if you have questions.

#### Usage Conditions

Epson products are designed to give highly reliable use and long life when used according to specifications. With any product or device used in situations where human life may be involved or at risk, Epson advises that you should take all necessary steps to ensure the suitability of your Epson product for inclusion in your system, and recommends that you include fail-safe procedures and redundancy support or backup equipment in your system, to maintain the maximum safety margin and optimum system reliability. Examples include but are not limited to – do not interfere with any electrical components within the device, do not use items supplied with the product for purposes other than as intended by Epson (ie mains cords, inks, CDs, plastic wrapping), do not make modifications to the product, take care with the use of 3rd party consumables, consult Epson if you have any questions or concerns.

## Consumables

INK CARTRIDGES	PRODUCT CODE
<a href="#">140ml UltraChrome T49F Dye Sub Fluro Pink Ink Bottle</a>	C13T49F800
<a href="#">140ml UltraChrome T49F Dye Sub Fluro Yellow Ink Bottle</a>	C13T49F700
<a href="#">140ml UltraChrome T49N Dye Sub Black Ink Bottle</a>	C13T49N100
<a href="#">140ml UltraChrome T49N Dye Sub Cyan Ink Bottle</a>	C13T49N200
<a href="#">140ml UltraChrome T49N Dye Sub Magenta Ink Bottle</a>	C13T49N300
<a href="#">140ml UltraChrome T49N Dye Sub Yellow Ink Bottle</a>	C13T49N400
LARGE FORMAT PAPERS	PRODUCT CODE
<a href="#">DS Transfer Universal 17" x 75m roll</a>	C13S450391
<a href="#">DS Transfer Universal 24" x 75m roll</a>	C13S450392
<a href="#">A3 x 100 Sheets General Purpose Transfer Paper</a>	C13S400077
<a href="#">A4 x 100 Sheets General Purpose Transfer Paper</a>	C13S400078
<a href="#">17" x 30.5m General Purpose Transfer Paper</a>	C13S400079
<a href="#">24" x 30.5m General Purpose Transfer Paper</a>	C13S400080
<a href="#">A3 x 30.5m General Purpose Transfer Paper</a>	C13S400081
<a href="#">A4 x 30.5m General Purpose Transfer Paper</a>	C13S400082
LARGEFORMATOPTIONS	PRODUCT CODE
<a href="#">24" Printer Stand</a>	C12C933151
<a href="#">Additional / Replacement Spindle</a>	C12C935701
<a href="#">Replacement Auto Cutter Blade</a>	C13S210055
<a href="#">Replacement Maintenance Tank</a>	C13S210057
<a href="#">SureColor-S/F/P Cleaning Sticks</a>	C13S090013
<a href="#">Epson Edge Print</a>	C12C934181
<a href="#">Cleaning Wipes (Pack of 100)</a>	C13S090016
<a href="#">Epson Edge Print PRO</a>	C12C936661

Epson is the registered trademark of Seiko Epson Corporation. Epson STYLUS, PerfectPicture, MicroPiezo, AcuPhoto Halftoning, QuickDry are the trademarks of Seiko Epson Corporation. All other names and company names used herein are for identification purpose only and may be the trademarks or registered trademarks of their respective owners. Epson disclaims any and all rights in those marks. All print samples shown herein are imulations. Specifications are subject to change without notice.